

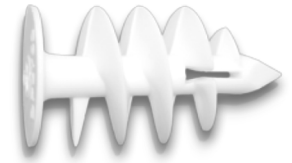

**New in the program**



**Art.-No. 12 210**

**„Turbo-Fix“ ...the dowel**

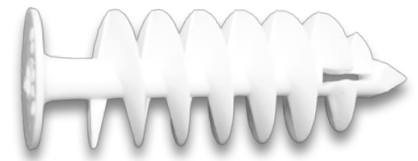

**for fixings in insulation boards made of polyurethane or polystyrene**

Suitable for light fixtures on unplastered and plastered facades and components where slabs made of polyurethane or polystyrene have been used.

The dowel with the specially shaped thread cuts flush and prevents a cold bridge in the insulation. A simple screw-in with a screwdriver or electric screwdriver and commercial bit T 40 saves time and money.

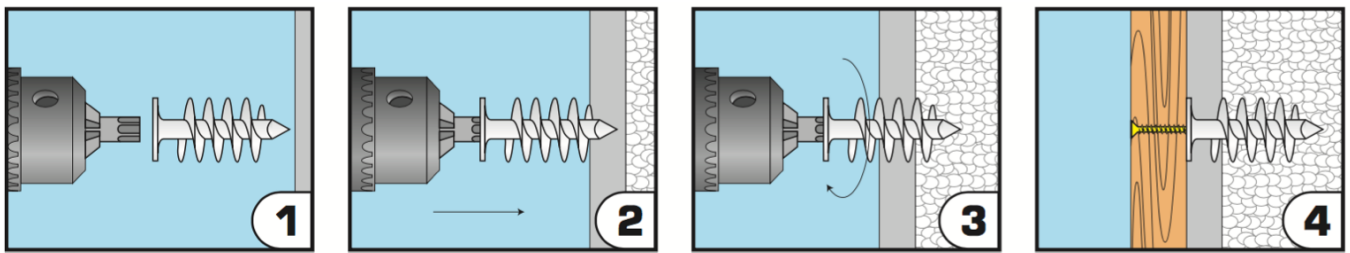

In case of lower loads (e.g. motion detector, house number plates) the short version with 52 mm length and screw  $\varnothing$  4.0 mm is used, at higher loads (e.g. letter boxes, outside lamps, billboards), the longer versions with 82 mm length and screws  $\varnothing$  4.5 mm processed.

**good - cheap - fast = „Turbo-Fix“**

Please contact us: [info@4-man.eu](mailto:info@4-man.eu)